

MV-RD Installation Instructions

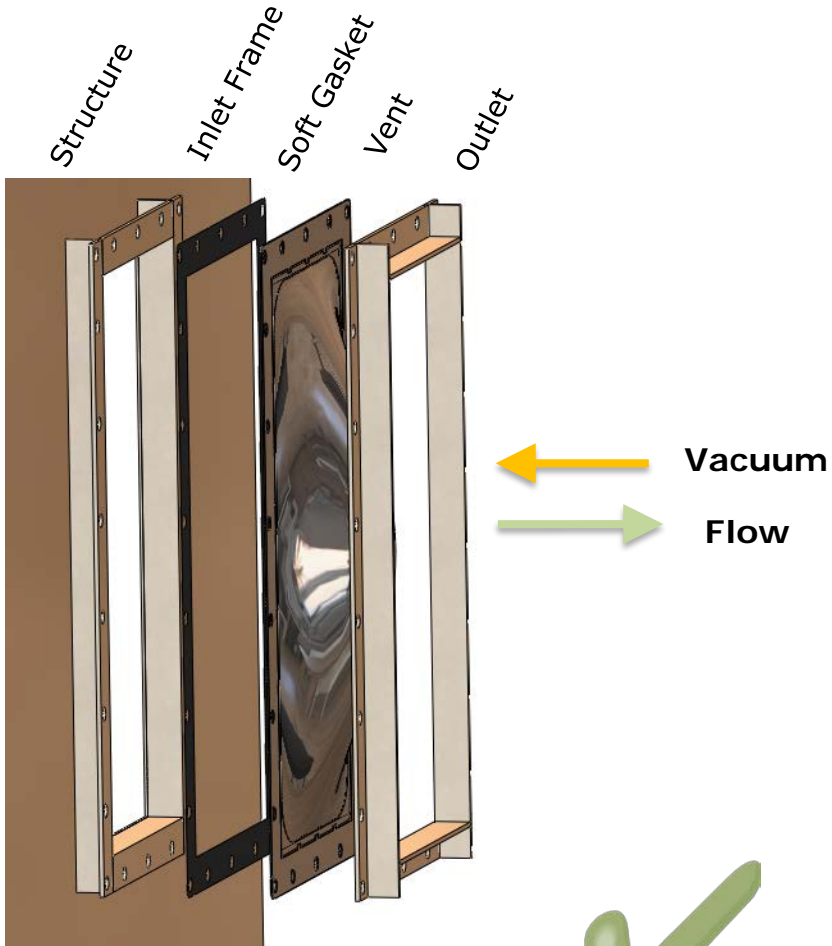

Ensure system is depressurized and safe for human exposure

Vent should have an open discharge area away from personnel and equipment

A soft gasket material is required between the Vent and the inlet Frame

Bolt Diameter	Torque (max)
1/2"	25 ft-lbs (300 in-lbs)

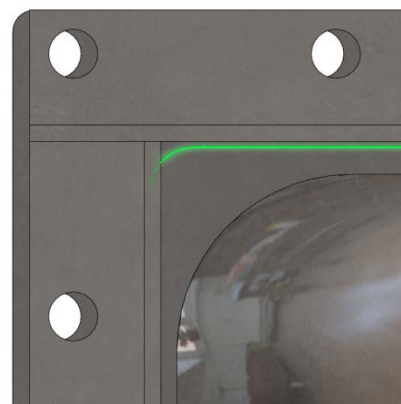
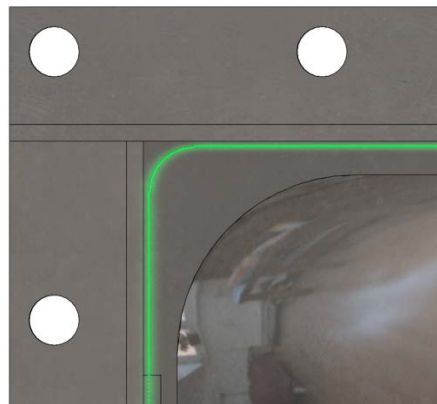

Frame must leave slit visible or vent will not open properly



MVRD Installation Instructions

Install bolting on [hinge side corners](#) and then [opposite corners](#), hand tightened only. Once all four corners are hand tightened, install bolting on the rest of the vent, hand tightened only. Incrementally torque all bolting in a star or crisscross pattern. **MVRD rupture vents are bolt torque sensitive** (i.e. over torquing can affect burst pressure).

**Note: The tag will always be opposite the hinge side.*

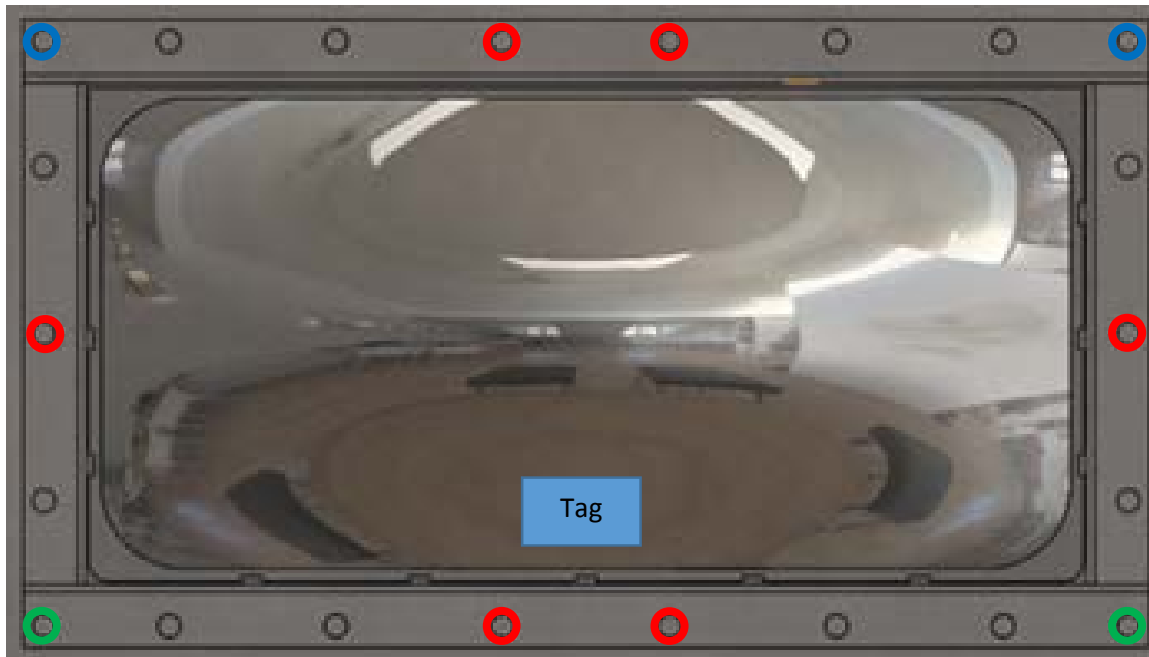

WARNING:

1. Bolting to a center point on a vent first instead of the hinge side corner can cause excessive flexure resulting in damage to the vent. Center points are not designed to support the weight of the whole vent while other bolting is being completed.
2. All bolting holes must be used to secure the vent or the manufacturing warranty is voided.
3. Do not force the vent into the frame, as it could bend tabs and keep it from operating as designed.